

SCALE 1:2.5

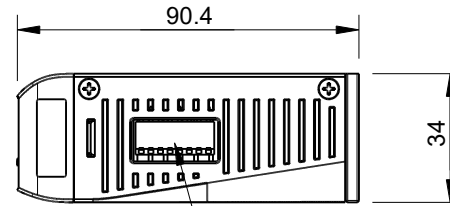

DIP Switch selector
EtherCAT ID

Tuning port Micro-USB
(Leadshine Motion Studio)

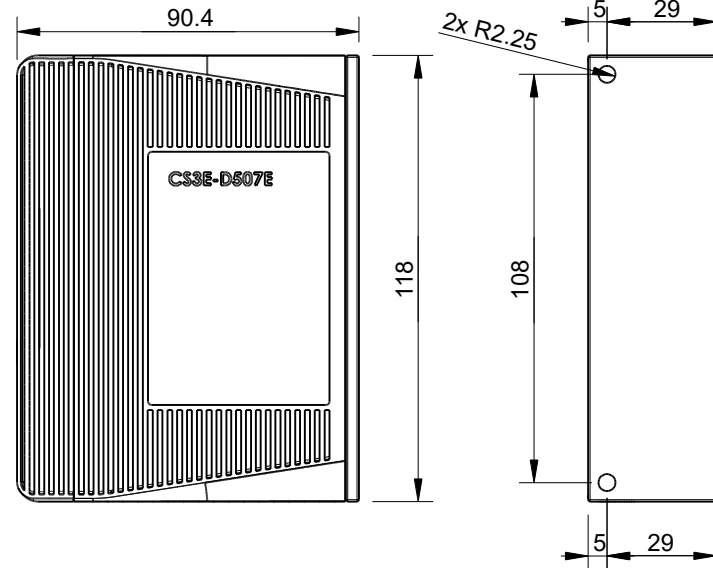
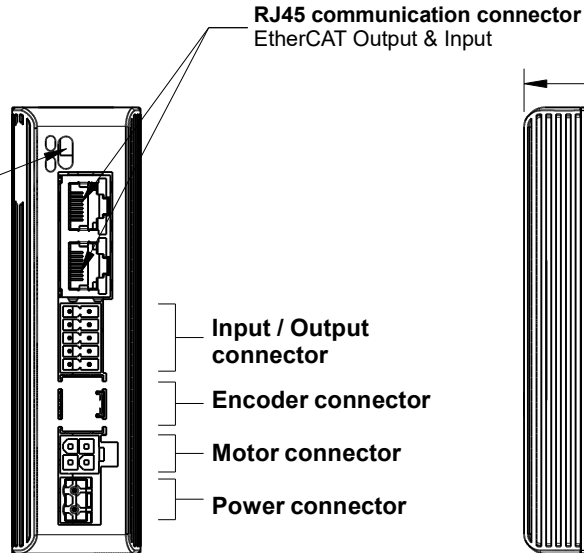

Command source	EtherCAT
Phase	2 Phase
Supply voltage	20-50 VDC
Output current	1.0-7.0 A
Number of Inputs	6
Input Voltage	12 - 24 VDC
Number of Outputs	2
Output Voltages	12 - 24 VDC
Cooling	Passive
Over-voltage/current protection	Yes
Matching motors	Nema 23 & 24 (1000-5000 PPR)
Operating Temperature	0-50 °C

Units	mm
Tolerances	± 0.1mm unless otherwise specified

Itemref	Quantity	Title/Name, designation, material, dimension etc			Article No./Reference	
Drawn by Cas Jansen	Checked by	Approved by - date	File name	Date 27-10-2022	Scale 1:2	

6016

www.damencnc.com

6016 EtherCAT Closed Loop Stepper Drive CS3E-D507E 50V 7,0A (2phase)	Edition	Sheet 1 OF 1
---	---------	-----------------